

# Xsum eXclusive

2 & 3 Bedroom Apartments for Sale in Canning Town, London. UK.

Prices from £400,000 to £850,000



**Jubilee Line from Canning Town**

North Greenwich 1 Stop	Canary Wharf 2 Stops	London Bridge 5 Stops	Waterloo 7 Stops
---------------------------	-------------------------	--------------------------	---------------------

**Elizabeth Line from Canary Wharf**

Stratford* 2 Stops	Liverpool Street 2 Stops	Bond Street 5 Stops	Heathrow Central 13 Stops
-----------------------	-----------------------------	------------------------	------------------------------

**DLR from Canning Town**

London City Airport 3 Stops	Canary Wharf** 5 Stops	Stratford 5 Stops	Bank 7 Stops
--------------------------------	---------------------------	----------------------	-----------------

**Cycle from Cerulean Quarter\*\*\***

Trinity Buoy Wharf 8 Mins	Canary Wharf 16 Mins	Stratford 20 Mins	Hackney Wick 26 Mins
------------------------------	-------------------------	----------------------	-------------------------

\*Includes changing at Whitechapel \*\*Includes changing at Poplar \*\*\*Cycle times as estimated by Google Maps  
All journey times are approximate, based on travel at peak times and subject to change from time to time.  
Source: Tf.gov.uk May 2023

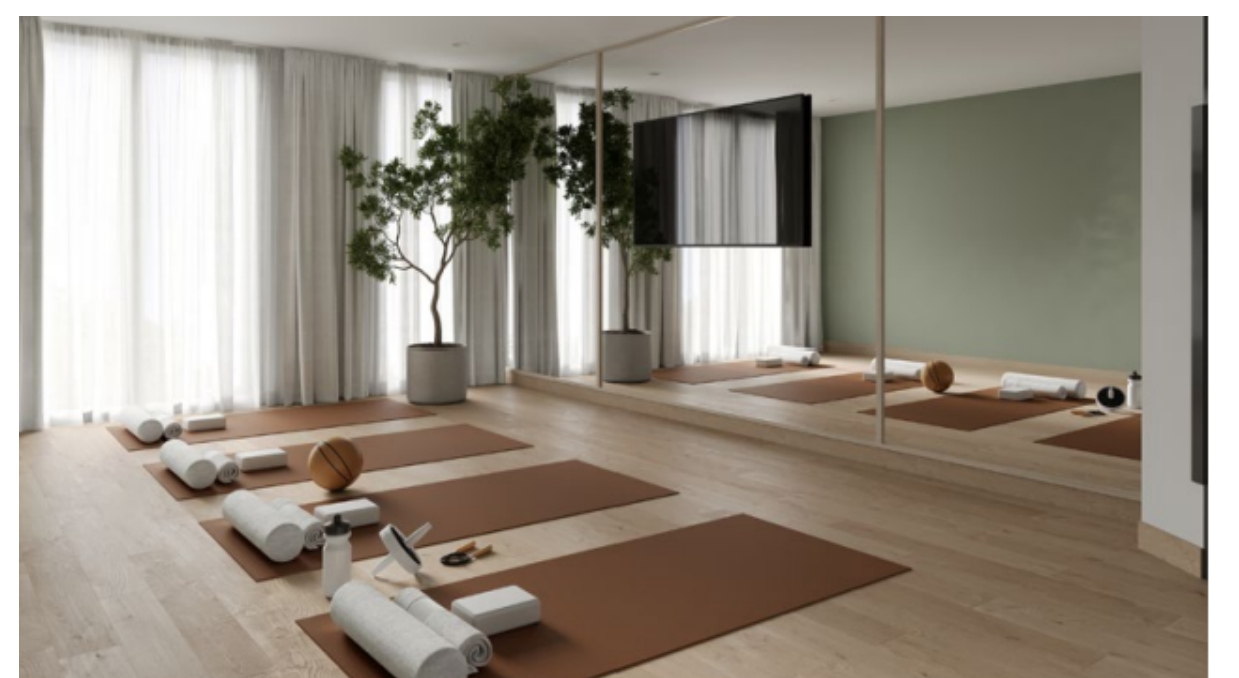

Introducing Cerulean Quarter, a new vibrant neighbourhood for East London and Canning Town - super connected with a brand new landscaped park to be enjoyed by all ages. The public park boasts in excess of 1.1 acres of green space and amenities including a jogging track, outdoor exercise equipment and even table tennis for those competitive games. Tree-lined with picnic benches, residents can enjoy life in colour, surrounded by nature. The Tower, in the first phase, is a 32 storey building offering 178 one, two and three bedroom apartments\* each complete with their own private balconies.